

CINDY DEVEANEU FITCH  
 6 ISLAND RD, WINCHENDON, MA  
 1ST FLOOR  
 OCT 18, 2022

EXISTING  
 REAR DECK  
 27' X 8'2"

4' SLIDING  
 WINDOW

KEEP CURRENT  
 WINDOW ABOVE  
 SINK

NEW  
 SLIDING  
 WINDOW

EXISTING  
 DINING AREA  
 12' X 11'6"

EXISTING  
 KITCHEN  
 12' X 11'6"

EXISTING  
 BATHROOM  
 6'2" X 8'1"

8'1" X 11'6"

CLOSET LOCATION  
 TO BE DETERMINED

EXISTING  
 LAKE SIDE DECK  
 12'6" X 32'5"

4' WIDE SLIDING  
 WINDOWS  
 LAKE SIDE

2' 8" DOORS  
 OR SLIDING  
 GLASS DOOR

ADD NEW RECESSED  
 CARRYING BEAM

NEW DOUBLE  
 HUNG WINDOW

BEDROOM #1  
 11' X 11'6"

NEW  
 PANTRY  
 CLOSET  
 5'6" X 11'

EXISTING  
 LIVING AREA  
 19' X 11'10"

DOWN TO  
 BASEMENT

ADD 1ST FLOOR  
 FRONT DOOR

LAKE SHORE

ISLAND ROAD

DATE:	6 ISLAND RD, WINCHENDON, MA	SCALE:	PROJECT:	DESIGNER:	DATE:
FILE:				PLAN A	

LAKE SHORE

6 ISLAND RD, WINCHENDON  
 Proposed 2nd floor  
 Oct 18, 2022

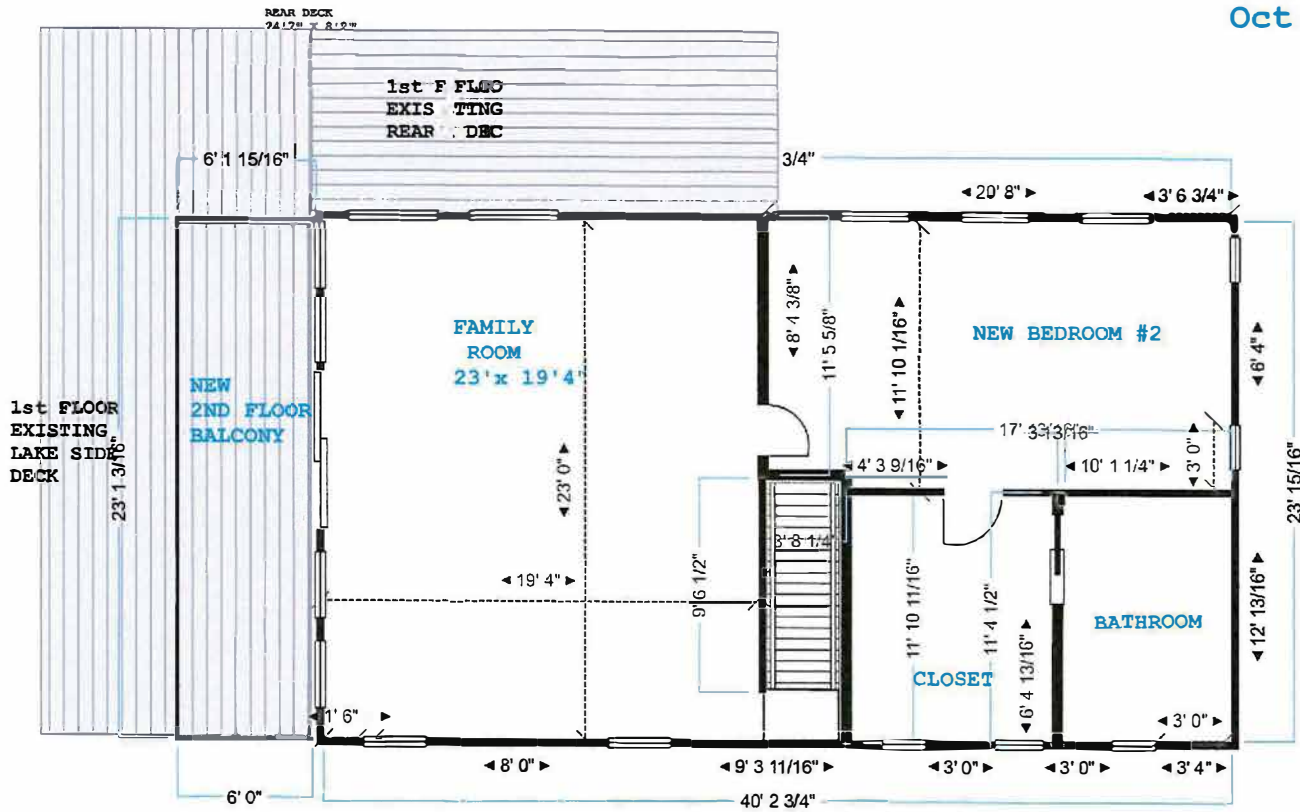

ISLAND ROAD

Site: 6 ISLAND RD, WINCHENDON, MA	Drawing: ORIGINAL	Project:	Drawn:	Notes:
Title :			Rev: A	